

# ASP FACTS

## FEATURE: Two-Sided Keyway

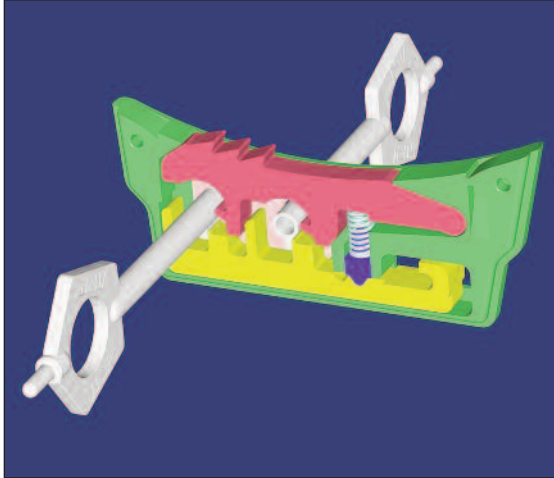

### ADVANTAGE:

Traditional handcuff training taught officers to position the "keyhole up." In the classroom, the emphasis was on "proper" technique. The reality of the street focused on "getting the cuffs applied." Tactical Handcuffs™ are designed for the "real police." Keyways are in both sides of each cuff. Now the emphasis can be on safe application. Whatever way the handcuff is applied, the keyway will always be up. To aid insertion, each keyway is beveled.

### SPECIFICATION:

- Keyway on each side of the cuff
- Beveled keyway
- Molded key posts
- Single and double unlock in same direction
- Cannot turn key in wrong direction
- Double lock slot on each side
- Beveled slot
- High visibility double lock indicator

### PERFORMANCE:

No other handcuff was designed from the ground up for the realities of street use. The double-sided keyway feature eliminates concern with proper application technique. Keyways and double lock slots are always conveniently accessible.

### SALES STRATEGY:

*Demonstrate the convenience of a Two-Sided Keyway. Show the advantages of a beveled keyway and double lock slot. Demonstrate that the key cannot turn in the wrong direction but will unlock both double and single locks with one turn. Point out the high visibility double lock indicator.*